



# HF-Matchbox Red

## HF-M RED 109 SH TL/PL-S 230-240V

HF-Matchbox Red is an affordable, reliable, compact, lightweight and high-frequency ballast for use with system wattages below 25 W in combination with TL mini, TL-D, TL5 and TL5c, PL-T/C, and PL-L/S lamps. The HF-M Red range has a robust design, meets all relevant international safety and performance standards and has an energy efficiency index (CELMA EEI ) of A2. The ballast is primarily designed for Indoor application. For outdoor application, the luminaire should be minimum Classland need to be sufficiently protected against water & dust. The installation should also be guard against any lightening surge or any other necessary electrical protection as deemed in such typical installation & application.

### Product data

| Operating and Electrical                     |                 |
|--|-----------------|
| Input Voltage                                | 230 to 240 V    |
| Line Frequency                               | 50 to 60 Hz     |
| Input Frequency                              | 50 to 60 Hz     |
| Number of Products on MCB (16A Type B) (Nom) | 159             |
| Wiring                                       |                 |
| Connector Type Input Terminals               | Insert          |
| Color Input Terminals                        | Black           |
| Color Output Terminals                       | Grey            |
| Connector Type Output Terminals              | Insert          |
| Cable Length From Device to Lamp             | 1.50 m          |
| Temperature                                  |                 |
| Ambient temperature range                    | -10 °C to 40 °C |
| T-Case Maximum (Max)                         | 75 °C           |

| Mechanical and Housing          |  |
|---------------------------------|--|
| Housing                         | SH   |
| Approval and Application        |  |
| Ingress protection code         | IP20 [Finger-protected]                              |
| Approval Marks                  | F-Marking CE marking ENEC certificate CB Certificate |
| Product Data                    |  |
| Order product name              | HF-M RED 109 SH TL/PL-S 230-240V                     |
| Full product name               | HF-M RED 109 SH TL/PL-S 230-240V                     |
| Full product code               | 871150093142930                                      |
| Order code                      | 913700422866   |
| Material Nr. (12NC)             | 913700422866   |
| Numerator - Quantity Per Pack   | 1  |
| EAN/UPC - Product/Case          | 8711500931429  |
| Numerator - Packs per outer box | 50   |
| EAN/UPC - Case                  | 8711500931436  |

# HF-Matchbox Red

## Dimensional drawing

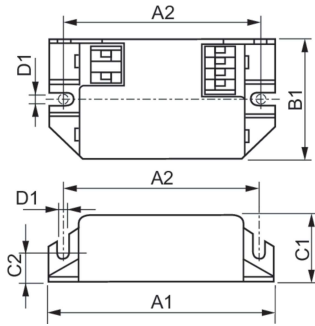

| Product                             | D1     | C1      | C2      | A1      | A2      | B1      |
|-------------------------------------|--------|---------|---------|---------|---------|---------|
| HF-M RED 109 SH TL/PL-S<br>230-240V | 4.4 mm | 22.0 mm | 10.0 mm | 80.0 mm | 70.0 mm | 40.0 mm |

