

Technical Information

No. DO 4233

Edition: 07/08 - subject to change

Supersedes /

Status: valid

Tungsten Halogen Lamp for Airfield Lighting

64338 AC



■ Product description

The OSRAM 64338 AC is a tungsten halogen lamp for the following applications:

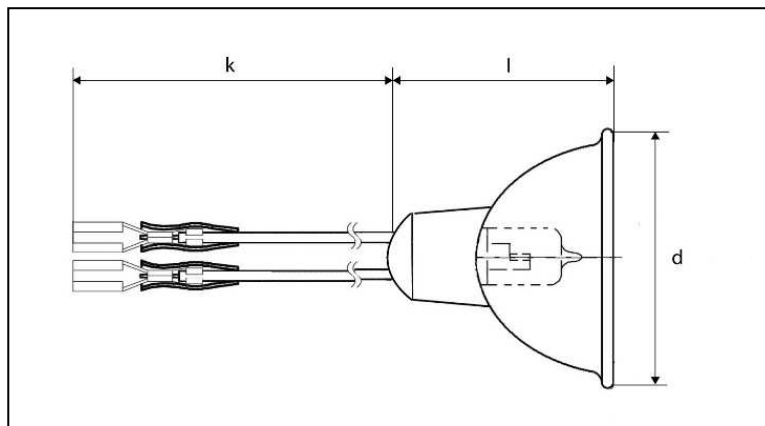
Approach, runway edge, threshold, touchdown zone, runway and taxiway lights.



■ Technical data

Order reference		64338 AC 48-10
Maximum operation current	A	6.6
Connector	 A	female ¹
	 C	male ²
Rated lamp wattage	W	48
Maximum initial wattage	W	53
Average life	h	1,000
Color temperature	K	3,300
Axial luminous intensity	cd	27,000
Minimum axial luminous intensity	cd	23,000
Axial luminous intensity after 750 h	cd	min. 75% of initial value
Reflector type		MR 16 parabolic reflector with durable dichroic coating
Reflector diameter (d)	mm	max. 50.4
Length (l)	mm	max. 45.0
Cable length (k)	mm	min. 125

■ Lamp operation

Burning position		horizontal
Maximum pinch temperature	°C	350
Chromaticity		within white boundaries as defined in Annex 14 to the Convention of International Civil Aviation

¹ Female connector A complies with DIN 46247

² Male connector C complies with DIN 46248